

Introduction

The few maintenance tasks and checks required to ensure reliable and safe day to day running of the vehicle are detailed in this section.

Only use lubricants and fluids which meet the specifications recommended by Jaguar Cars Limited.

Regular Checks

In the interests of safety and reliability, it is advisable to carry out the following checks at the recommended intervals, and always before starting on a long journey.

Daily

Check that there is sufficient fuel for the journey intended, particularly at night and before entering motorways.

Check that there is adequate windscreen washer fluid for the intended journey.

Weekly

Tyres – Check the tyres, including the spare, for condition and pressure. See Section 6 for the recommended tyre pressures.

Lights – Check that all exterior lights and direction indicators function correctly and that the lenses are clean.

Engine Oil – With the vehicle standing on level ground, check the oil level and top up if necessary with oil of the correct grade, see page 3-3, 3-4 and 3-8.

Engine Coolant – With the engine **cold**, check the level of the coolant in the engine header tank, see page 3-3, 3-4 and 3-7. Any loss of fluid must be checked by a Jaguar Dealer.

Brake Fluid – Check the level of the fluid in the brake fluid reservoir, see page 3-3 and 3-6. Top up if necessary with new, unused Jaguar approved brake fluid.

The brake fluid reservoir is initially nearly full, but the level will drop as the brake pads wear. If the level appears unusually low, location of the fluid leakage **must** be checked by a Jaguar Dealer.

Power Steering Fluid – With the engine cold check the level of the fluid in the power steering fluid reservoir, see page 3-3 and 3-6. Top up if necessary with fluid of the correct specification. Any loss of fluid should be checked by a Jaguar Dealer.

Note: The transmission and, where fitted, the supercharger are sealed for life units and do not require topping up.

Monthly

Windscreen Washer – Top up with recommended windscreen washer fluid and clean soft water, see page 3-3 and 3-5. Check the operation of the washer. Use Jaguar Windscreen Washer Fluid additive to prevent freezing.

Wiper Blades – Check the quality of the wipe. If smearing or juddering is evident, clean the windscreen as detailed in Section 5 and renew the wiper blades.

3-2 Routine checks

Tyre Pressure Check

Certain alloy wheels have a slotted screw valve cover on the wheel face. To access the valve, adopt the following procedure.

Locate Pouch

A pouch containing a 'T'-shaped screwdriver and a valve adaptor, is stowed in the glovebox.

Fit Adaptor

On the wheel face, locate the slotted screw valve cover.

Loosen and remove it with the screwdriver (1).

Fit and hand tighten the adaptor (2) to the valve.

Position tyre pressure gauge on the adaptor and take the reading.

Note: Recommended tyre pressures are given on page 6-7.

Remove Adaptor and Stow Pouch

On completion of the tyre pressure check, loosen and remove the adaptor, refit the slotted screw valve cover and tighten with the screwdriver.

Return the adaptor and screwdriver to the pouch and stow in the glovebox.

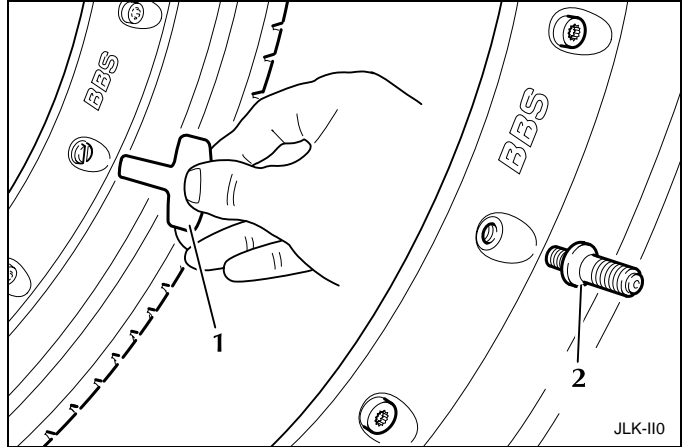

Reservoir and Dipstick Locations

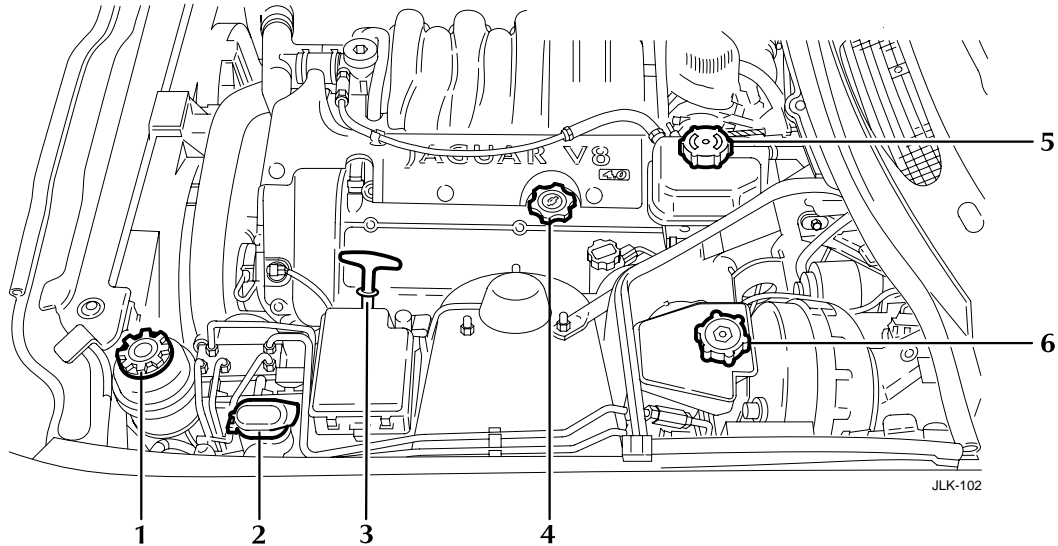

- | | |
|--------------------------------|--------------------------------|
| 1. Power steering reservoir | 4. Engine oil filter |
| 2. Windscreen washer reservoir | 5. Coolant filter pressure cap |
| 3. Engine oil dipstick | 6. Brake fluid reservoir |

3-4 Routine checks

Checking and Replenishment

Check/Top Up Engine Oil Level

Check the oil level regularly with the vehicle on flat, level ground.

Refer to page 3-3 for dipstick and oil filler locations.

It is preferable to check the oil level after the vehicle has been standing, that is, with the engine completely cold.

If the engine has been started do not check the oil level until the engine has reached normal operating temperature.

Stop the engine and wait for a minimum of two minutes to allow the oil to drain back into the sump.

Remove the dipstick and wipe clean with a non-fluffy cloth. Replace fully, then withdraw the dipstick.

The oil level is correct when it is at the top of the crosshatched section.

The difference in oil quantity between the lower edge of the crosshatched section (MIN) and the top of the crosshatched section is 1 quart (1 litre).

The oil must not be allowed to exceed the MAX level.

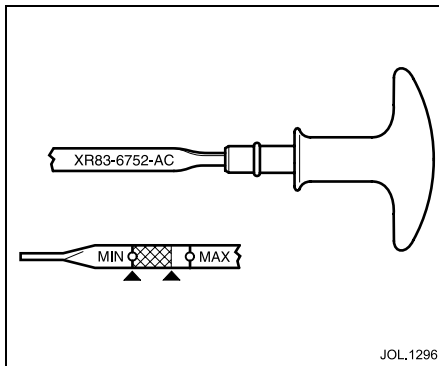

To top up, remove the oil filler cap and add oil to the correct specification as detailed on page 3-8.

Caution: Do not use oil additives of any type. Use only specified lubricants.

Refit the filler cap and hand tighten securely.

The supercharger (where fitted) is oil filled-for-life and does not require any checks to be made by the driver.

Checking Coolant Level

The coolant level must only be checked when the engine is COLD.

See page 3-3 for coolant header tank location and page 3-7 for the coolant specification.



WARNING:

Do not remove the coolant expansion tank filler/pressure cap while the engine is hot. If the cap must be removed, protect the hands against escaping steam and slowly turn the cap anticlockwise until the steam pressure starts to escape. Leave the cap in this position until all the pressure has escaped, and then remove the cap completely.

The coolant level should be up to the bottom of the filler neck of the header tank. If persistent coolant loss is noticed have a Jaguar Dealer investigate the cause immediately.

Refit the filler cap and hand tighten securely.

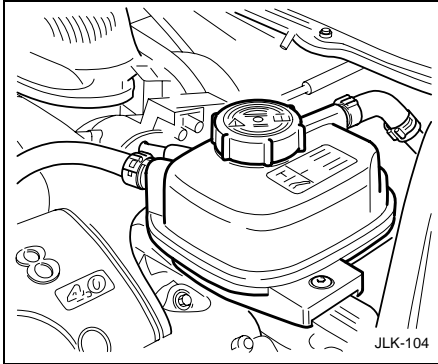

Topping up

Caution: Antifreeze will damage paintwork. Avoid spillage.

With the engine cold, top up the header tank until the coolant is level with the bottom of the filler neck.

Use the correct concentration of Jaguar Antifreeze/Coolant/ Corrosion Inhibitor as detailed on page 3-7.

Check/Top Up Windscreen Washer/ Powerwash Reservoir

See page 3-3 for windscreen washer reservoir location.

The washer reservoir contains the fluid for the windscreen washers and the headlamp powerwash system (where fitted).

Fill to just below the neck with Jaguar Windscreen Washer Fluid diluted with clean, preferably soft water as specified in the maker's instructions on the bottle.

Do not over-fill.

Note: Using a non-approved fluid may adversely affect the rubber of the windscreen wiper blades, resulting in ineffectual and noisy wiping.

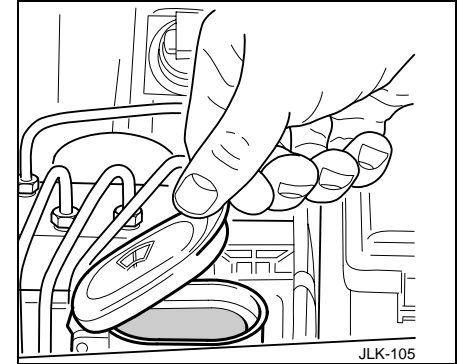

Cold Weather Precautions

To prevent damage to the pump under freezing conditions, use recommended Jaguar Windscreen Washer Fluid.

Caution:

- 1. Windscreen washer fluid is toxic and in concentrated form is flammable.**
- 2. Under no circumstances must cooling system antifreeze be used, since this will damage the paintwork.**

After adding screen washer fluid to the reservoir, operate the pump until untreated water is purged from the pipes and jets.

3-6 Routine checks

Check/Top Up Brake Fluid Reservoir



WARNING:

The brake fluid level will drop as the brake pads wear. If the level is very low report the loss of fluid to the nearest Jaguar Dealer. Do not drive the vehicle until the cause is rectified.

Caution:

1. While handling brake fluid, take extreme care; brake fluid must not contact the vehicle paintwork.
2. Always use fresh, clean fluid from a new container. Never introduce used brake fluid into the system.

See page 3-3 for brake fluid reservoir location.

The fluid is visible through the translucent casing of the reservoir and must be maintained at the 'MAX' mark.

If necessary, top up as follows:

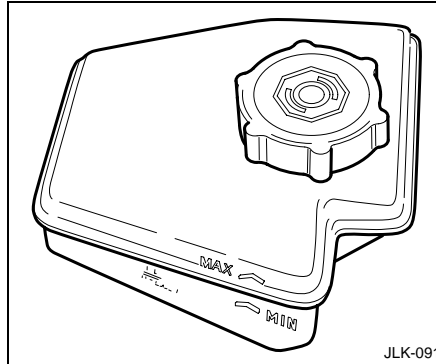

Before removing the cap, clean the reservoir and cap thoroughly with a lint free cloth to ensure that no foreign matter enters the reservoir.

Unscrew the filler cap and top up to the 'MAX' level using new Jaguar brake fluid, specification JAGUAR ITT SUPER DOT 4. This is a non-mineral polyglycol based brake fluid.

Refit the filler cap securely.

Should any brake fluid be spilt, replace the cap on the reservoir before rinsing it away, to avoid contamination.

Check/Top Up Power Steering Fluid Reservoir

Caution: It is imperative that the power steering system does not become contaminated in any way. Always dispense fluid from a fresh sealed container and clean the area around the reservoir neck both before and after topping up. Never return drained fluid to the system.

See page 3-3 for power steering fluid reservoir location.

Check the fluid level when the engine is 'COLD' and the vehicle is on a flat, level surface.

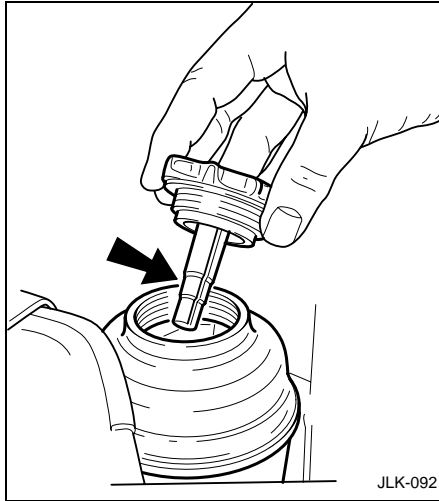

Wipe clean and remove the filler cap from the reservoir; take great care to prevent any foreign matter from entering. Check that the fluid level is between the marks on the dipstick.

If necessary, top up with DEXRON III fluid, **DO NOT OVERFILL.**

Should the level be very low, report the loss of fluid to the nearest Jaguar Dealer.

Cooling System

The cooling system should be filled or topped up with a mixture of 50% plain water and 50% Jaguar Antifreeze, Coolant and Corrosion Inhibitor conforming to specification:

WSS M97B44-D,

coloured orange, Extended Life Coolant.

This antifreeze mixture gives frost protection for temperatures down to -40°F (-40°C).

Caution: Do not mix with anti-freeze of a different specification as this would damage the cooling system.

Engine Antifreeze

Antifreeze, when used at the correct concentration, not only protects the engine from frost damage in winter, it also provides all year round protection against internal corrosion.

Use only antifreeze to specification, WSS M97B44-D, coloured orange, Extended Life Coolant. Inferior quality antifreeze may be ineffective in maintaining adequate frost and corrosion protection to the cooling system.

The coolant solution may remain in the cooling system for five years or, 150 000 miles (240 000 kilometres) after which the cooling system should be drained, flushed and refilled.



WARNING:

Do not allow antifreeze to make contact with skin or eyes. If this should happen, rinse the affected area immediately with plenty of water.

Engine Block Heater

If the vehicle is to be started at temperatures of -22°F (-30°C) and lower, it is recommended that an engine block heater is fitted and used. Failure to do so may result in damage to the drive belt.

For further information consult your Jaguar Dealer.

Caution: The fitting of an engine block heater does not eliminate (lessen) the need for antifreeze under freezing conditions.

3-8 Routine checks

Recommended Engine Oil

Oil Specification

API SJ / EC and ILSAC GF-2.

When topping up between oil changes, make sure that you use oil that has the correct quality level (API service) and viscosity grade. Your vehicle's warranty may be invalidated if damage is caused by use of improper engine oil.

When the oil level is at the lower dipstick mark, add one quart (one litre) of engine oil.

SAE Viscosity Rating

It is recommended that you use only approved engine oils to meet the SAE Viscosity Range / Ambient Temperature Scale shown below. For maximum fuel economy, 5W/30 oil is recommended.

Caution: Do not use oil additives of any type. Use only specified lubricants.

Recommended SAE Viscosity Range / Ambient Temperature Scale

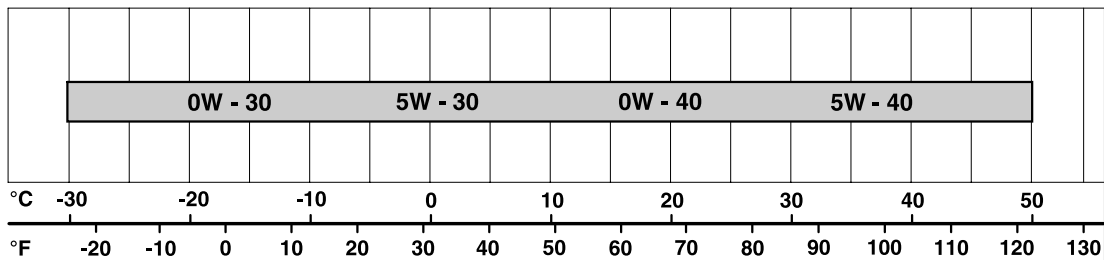

JOL.654

Capacities

| | US Quarts | Litres |
|---|------------------|---------------|
| Engine oil: service oil change with new oil filter | | |
| – with or without oil cooler | 7.4 | 7 |
| <p>The rear axle (final drive unit), automatic transmission unit and supercharger (where fitted) are oil filled-for-life and will not normally require to be topped up.</p> | | |
| <p>Cooling system, including reservoir and climate control:</p> | | |
| – Initial fill – 4.0 litre normally aspirated | 10.0 | 9,5 |
| – Initial fill – 4.0 litre supercharged | 12.2 | 11,5 |
| Windscreen Washer Reservoir | 7.4 | 7,0 |

Capacities - Fuel Tank

| | US Gallons | Litres |
|--|-------------------|---------------|
| Indicated refill capacity (E to F on fuel gauge) | 18.5 | 70,0 |
| Unindicated capacity (Below E on fuel gauge) | 1.3 | 5,0 |
| Total refill capacity | 19.8 | 75,0 |

3-10 Routine checks
